



ADDENDUM NO.: FIVE DATE: 20 March 2014

PROJECT TITLE: Indoor Practice Facility Construction
University of South Carolina
Columbia, South Carolina

PROJECT NO.: State #H27-6090-MJ WTS No. 12710

WRITTEN BY: Gene Bell, AIA, LEED-AP

TO: Prospective Bidders / Plan Holders

This addendum is issued pursuant to Article 1.1.1 of the AIA General Conditions of the Contract (A201) in connection with the revision of Bidding Documents which have been previously issued.

Addenda are issued prior to execution of Contract. All instructions contained herein shall be reflected in the Contract Sum and this Addendum will be made a part of the Contract Documents, if, as, and when a Construction Contract is awarded.

This Addendum forms a part of the Contract Documents and modifies the original documents dated February 5, 2014, as noted below. Acknowledge receipt of this Addendum in this space provided on the Bid Form. Failure to do so will subject the Bidder to disqualification.

This Addendum consists of 1 pages and the following attachments:

C-201 GRADING AND SWPP PLAN 01 Sheet

- A. CLARIFICATIONS - None
B. REVISIONS TO PREVIOUS ADDENDA: None
C. REVISIONS TO THE PROJECT MANUAL: None

- D. REVISIONS TO DRAWINGS:
1. C-201 Grading and SWPP Plan – replace sheet C-201 with the attached, C-201.

- E. QUESTIONS:
1. Addenda one A/1/a states that items that are OFOI include “Interior Field Turf, including the subgrade. Note that drainage piping is included in the base bid.” Is “drainage piping” referring to the sanitary sewer only and not the panel drains?
a. The field drainage shown under the field on sheet A-101 is part of the base bid. Sanitary sewer lines are also required as shown on other drawings.
2. Addenda one A/1/b. states that items that are OFOI include “Exterior Field Turf. Subgrade at exterior only is included in the base bid.” Please confirm that nothing above subgrade is included in the base bid.
a. See detail 7/SR-601, which clearly delineates what is to be Owner provided. All other items are in the bid.
3. Spec section 334600 Subdrainage, has a section pertaining to foundation drains. None are shown on the drawings. Are foundation drains as described in spec section 334600/3.3 required?
a. Foundation drains are not required for this project.

END OF ADDENDUM

These drawings are the property of Watson Tate Savory, Inc. and may not be used in whole or in part without written consent of the architect and any infringement is subject to legal action.

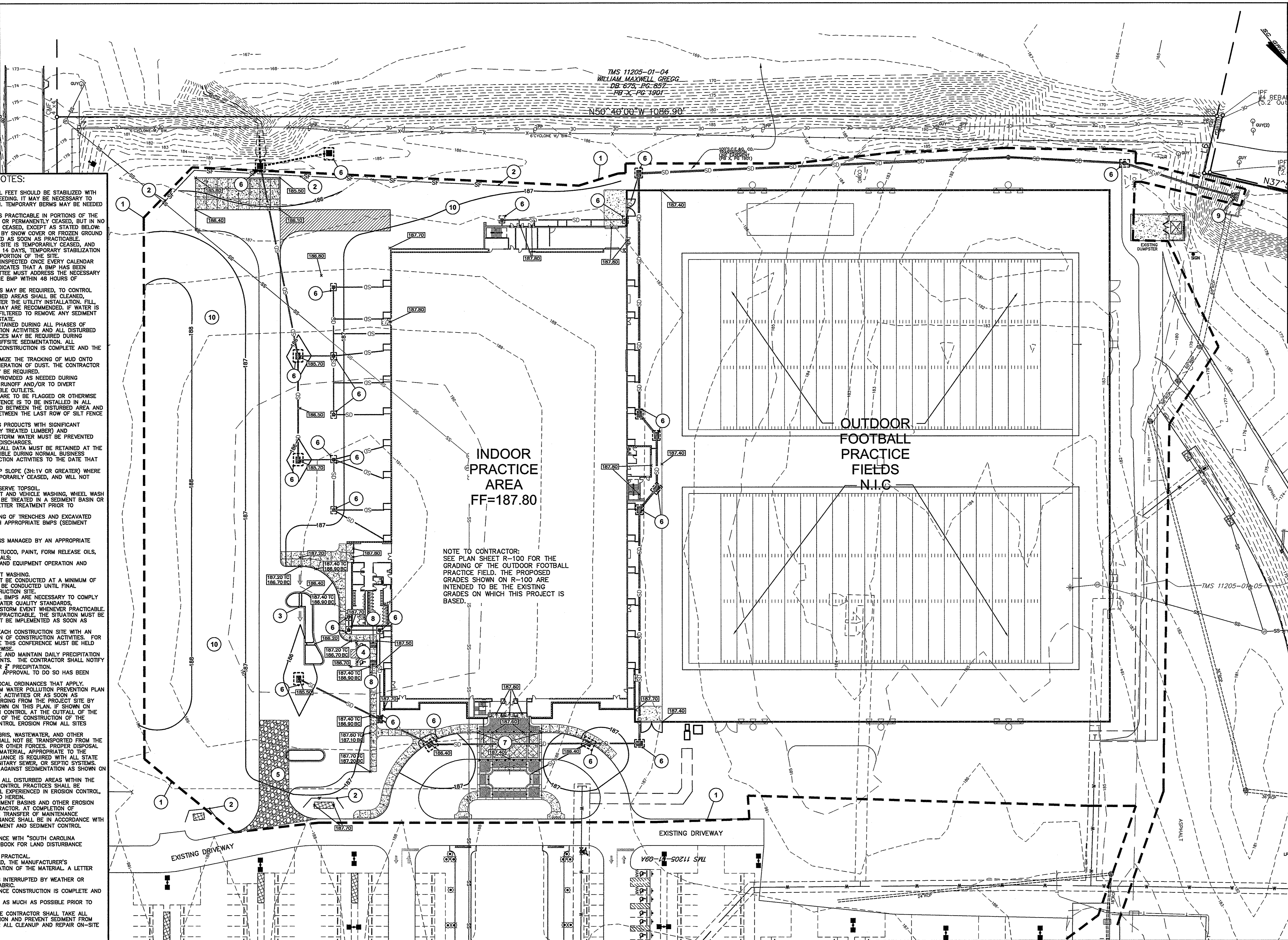
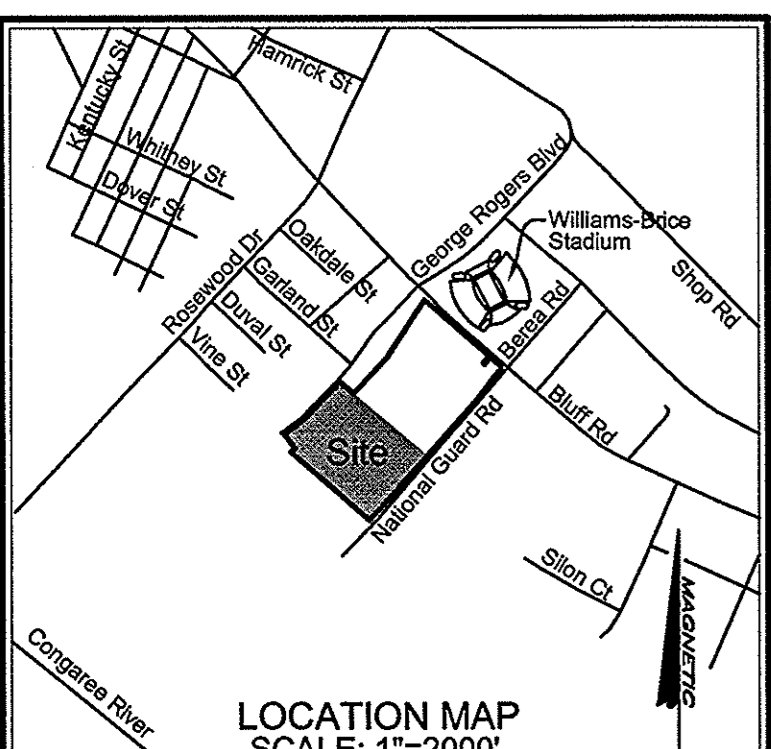

- SEDIMENT AND EROSION CONTROL NOTES:**
1. IF NECESSARY, SLOPES, WHICH EXCEED EIGHT (8) VERTICAL FEET SHOULD BE STABILIZED WITH SYNTHETIC OR VEGETATIVE MATS, IN ADDITION TO HYDROSEEDING. IT MAY BE NECESSARY TO INSTALL TEMPORARY SLOPE GRASS DURING CONSTRUCTION. TEMPORARY BERMS MAY BE NEEDED UNTIL THE SLOPE IS BROUGHT TO GRADE.
 2. STABILIZATION MEASURES SHALL BE INITIATED AS SOON AS PRACTICABLE IN PORTIONS OF THE SITE WHERE CONSTRUCTION ACTIVITIES HAVE TEMPORARILY OR PERMANENTLY CEASED, BUT IN NO CASE MORE THAN FOURTEEN (14) DAYS AFTER WORK HAS CEASED, EXCEPT AS STATED BELOW:
 - WHERE STABILIZATION BY THE 14th DAY IS PRECLUDED BY SNOW COVER OR FROZEN GROUND CONDITIONS, STABILIZATION MEASURES MUST BE INITIATED AS SOON AS PRACTICABLE.
 - WHERE CONSTRUCTION ACTIVITY ON A PORTION OF THE SITE IS TEMPORARILY CEASED, AND EARTH-DISTURBING ACTIVITIES WILL BE RESUMED WITHIN 14 DAYS, TEMPORARY STABILIZATION MEASURES DO NOT HAVE TO BE INITIATED ON THAT PORTION OF THE SITE.
 3. ALL SEDIMENT AND EROSION CONTROL DEVICES SHALL BE INSPECTED ONCE EVERY CALENDAR WEEK. IF PERIODIC INSPECTION OR OTHER INFORMATION INDICATES THAT A BMP HAS BEEN INAPPROPRIATELY OR INCORRECTLY INSTALLED, THE PERMITTEE MUST ADDRESS THE NECESSARY REPAIRS OR MODIFICATIONS TO CORRECT THE BMP WITHIN 48 HOURS OF IDENTIFICATION.
 4. PROVIDE SILT FENCE AND/OR OTHER CONTROL DEVICES, AS MAY BE REQUIRED, TO CONTROL SOIL EROSION DURING UTILITY CONSTRUCTION. ALL DISTURBED AREAS SHALL BE CLEANED, GRADED, AND STABILIZED WITH GRASSING IMMEDIATELY AFTER THE UTILITY INSTALLATION. FILL COVER, AND TEMPORARY SEEDING AT THE END OF EACH DAY ARE RECOMMENDED. IF WATER IS ENCOUNTERED WHILE TRENCHING, THE WATER SHOULD BE FILTERED TO REMOVE ANY SEDIMENT BEFORE BEING PUMPED BACK INTO ANY WATERS OF THE STATE.
 5. ALL EROSION CONTROL DEVICES SHALL BE PROPERLY MAINTAINED DURING ALL PHASES OF CONSTRUCTION IN ORDER TO CONTROL EROSION AND/OR OFFSITE SEDIMENTATION. ALL TEMPORARY CONTROL DEVICES SHALL BE REMOVED ONCE CONSTRUCTION IS COMPLETE AND THE SITE IS STABILIZED.
 6. THE CONTRACTOR MUST TAKE NECESSARY ACTION TO MINIMIZE THE TRACKING OF MUD ONTO PAVED ROADWAY(S) FROM CONSTRUCTION AREAS AND GENERATION OF DUST. THE CONTRACTOR SHALL DAILY REMOVE MUD/SOIL FROM PAVEMENT, AS MAY BE REQUIRED.
 7. TEMPORARY DIVERSION BERMS AND/OR DITCHES WILL BE PROVIDED AS NEEDED DURING CONSTRUCTION TO PROTECT WORK AREAS FROM UPSLOPE RUNOFF AND/OR TO DIVERT SEDIMENT-LADEN WATER TO APPROPRIATE TRAPS OR STABLE OUTLETS.
 8. ALL WATERS OF THE STATE (WOS), INCLUDING WETLANDS, ARE TO BE FLAGGED OR OTHERWISE CLEARLY MARKED IN THE FIELD. A DOUBLE ROW OF SILT FENCE IS TO BE INSTALLED IN ALL AREAS WHERE A 50-FOOT BUFFER CANNOT BE MAINTAINED BETWEEN THE DISTURBED AREA AND ALL WOS. A 10-FOOT BUFFER SHOULD BE MAINTAINED BETWEEN THE LAST ROW OF SILT FENCE AND ALL WOS.
 9. LITTER, CONSTRUCTION DEBRIS, OILS, FUELS, AND BUILDING PRODUCTS WITH SIGNIFICANT POTENTIAL FOR IMPACT (SUCH AS STOCKPILES OF FRESHLY TREATED LUMBER) AND CONSTRUCTION CHEMICALS THAT MAY BE EXPOSED TO STORM WATER MUST BE PREVENTED FROM BECOMING A POLLUTANT SOURCE IN STORM WATER DISCHARGES.
 10. A COPY OF THE SWPPP, INSPECTION RECORDS, AND RAINFALL DATA MUST BE RETAINED AT THE CONSTRUCTION SITE OR NEARBY LOCATION EASILY ACCESSIBLE DURING BUSINESS HOURS, FROM THE DATE OF COMMENCEMENT OF CONSTRUCTION ACTIVITIES TO THE DATE THAT FINAL STABILIZATION IS COMPLETED.
 11. INITIATE STABILIZATION MEASURES ON ANY EXPOSED STEEP SLOPE (3H:1V OR GREATER) WHERE LAND-DISTURBING ACTIVITIES HAVE PERMANENTLY OR TEMPORARILY CEASED, AND WILL NOT RESUME FOR A PERIOD OF 7 CALENDAR DAYS.
 12. MINIMIZE SOIL COMPACTION AND, UNLESS INFEASIBLE, PRESERVE TOPSOIL.
 13. MINIMIZE THE DISCHARGE OF POLLUTANTS FROM EQUIPMENT AND VEHICLE WASHING. WASH WATER, AND OTHER WASH WATERS, WASH WATERS MUST BE TREATED IN A SEDIMENT BASIN OR ALTERNATIVE CONTROL THAT PROVIDES EQUIVALENT OR BETTER TREATMENT PRIOR TO DISCHARGE.
 14. MINIMIZE THE DISCHARGE OF POLLUTANTS FROM DEWATERING OF TRENCHES AND EXCAVATED AREAS. THESE DISCHARGES ARE TO BE ROUTED THROUGH APPROPRIATE BMPs (SEDIMENT BASIN, FILTER BAG, ETC.).
 15. THE FOLLOWING DISCHARGES FROM SITE ARE PROHIBITED:
 - WASTEWATER FROM THE WASHOUT OF CONCRETE, UNLESS MANAGED BY AN APPROPRIATE CONTROL.
 - WASTEWATER FROM THE WASHOUT AND CLEANOUT OF STUCCO, PAINT, FORM RELEASE OILS, CURING COMPOUNDS AND OTHER CONSTRUCTION MATERIALS.
 - FUELS, OILS, OR OTHER POLLUTANTS USED IN VEHICLE AND EQUIPMENT OPERATION AND MAINTENANCE.
 - SOAPS AND SOLVENTS USED IN VEHICLE AND EQUIPMENT WASHING.
 16. AFTER CONSTRUCTION ACTIVITIES BEGIN, INSPECTIONS MUST BE CONDUCTED AT A MINIMUM OF ONCE AT LEAST ONCE EVERY CALENDAR WEEK AND MUST BE CONDUCTED UNTIL FINAL STABILIZATION IS REACHED ON ALL PORTIONS OF THE CONSTRUCTION SITE.
 17. IF EXISTING BMPs NEED TO BE MODIFIED OR IF ADDITIONAL BMPs ARE NECESSARY TO COMPLY WITH THE REQUIREMENTS OF THIS PERMIT AND/OR SO'S WATER QUALITY STANDARDS, IMPLEMENTATION MUST BE COMPLETED BEFORE THE NEXT STORM EVENT IS PRACTICABLE. IF IMPLEMENTATION BEFORE THE NEXT STORM EVENT IS IMPRACTICABLE, THE SITUATION MUST BE DOCUMENTED IN THE SWPPP AND ALTERNATIVE BMPs MUST BE IMPLEMENTED AS SOON AS REASONABLY POSSIBLE.
 18. A PRE-CONSTRUCTION CONFERENCE MUST BE HELD FOR EACH CONSTRUCTION SITE WITH AN APPROVED ON-SITE SWPPP PRIOR TO THE IMPLEMENTATION OF CONSTRUCTION ACTIVITIES. FOR NON-LINEAR PROJECTS THAT DISTURB 10 ACRES OR MORE THIS CONFERENCE MUST BE HELD UNLESS THE DEPARTMENT HAS APPROVED AN ALTERNATIVE MEETING PROCEDURE.
 19. THE CONTRACTOR SHALL MAINTAIN A RAIN GAUGE ON SITE AND MAINTAIN DAILY PRECIPITATION RECORDS IN THE SWPPP MANUAL PER SCDD'S REQUIREMENTS. THE CONTRACTOR SHALL NOTIFY THE SWPPP INSPECTOR OF ALL RAINFALL EVENTS OF OVER 4 INCHES.
 20. LAND DISTURBING ACTIVITIES SHALL NOT COMMENCE UNTIL APPROVAL TO DO SO HAS BEEN ISSUED BY CONSERVATION AUTHORITIES.
 21. THE CONTRACTOR SHALL COMPLY WITH ALL STATE AND LOCAL ORDINANCES THAT APPLY.
 22. THE EROSION CONTROL MEASURES INCLUDED IN THE STORM WATER POLLUTION PREVENTION PLAN SHALL BE INSTALLED PRIOR TO INITIAL LAND DISTURBANCE OR AS SOON AS PRACTICABLE. SEDIMENT SHALL BE PREVENTED FROM DISCHARGING FROM THE PROJECT SITE BY INSTALLING AND MAINTAINING CONSTRUCTION PRACTICES AS SHOWN ON THIS PLAN. IF CHANGES TO THESE PLANS, ENERGY-DISSIPATION DEVICES OR EROSION CONTROL AT THE OUTFALL OF THE STORM SEWER SYSTEM SHALL BE INSTALLED AT THE TIME OF THE CONSTRUCTION OF THESE PLANS. STRUCTURAL PRACTICES SHALL BE USED TO CONTROL EROSION FROM ALL SITES REMAINING UNDISTURBED FOR MORE THAN 14 DAYS.
 23. THE CONTRACTOR SHALL CONTROL WASTES, GARBAGE, DEBRIS, WASTEWATER, AND OTHER SUBSTANCES ON THE SITE IN SUCH A WAY THAT THEY SHALL NOT BE TRANSPORTED FROM THE SITE BY THE ACTION OF WINDS, STORM WATER RUNOFF, OR OTHER MEANS. PROPER DISPOSAL OR MANAGEMENT OF ALL WASTES AND UNUSED BUILDING MATERIAL, APPROPRIATE TO THE NATURE OF THE WASTE OR MATERIAL IS REQUIRED. COMPLIANCE IS REQUIRED WITH ALL STATE OR LOCAL REGULATIONS REGARDING WASTE DISPOSAL, SANITARY SEWER, OR SEPTIC SYSTEMS.
 24. ALL ON-SITE STORM DRAIN INLETS SHALL BE PROTECTED AGAINST SEDIMENTATION AS SHOWN ON THESE PLANS.
 25. THIS EROSION CONTROL PLAN SHALL BE IMPLEMENTED ON ALL DISTURBED AREAS WITHIN THE CONSTRUCTION SITE. ALL MEASURES INVOLVING EROSION CONTROL PRACTICES SHALL BE INSTALLED UNDER THE GUIDANCE OF QUALIFIED PERSONNEL EXPERIENCED IN EROSION CONTROL, AND FOLLOWING THE PLANS AND SPECIFICATIONS INCLUDED HEREIN.
 26. DURING THE PERIOD OF CONSTRUCTION ACTIVITY, ALL SEDIMENT BASINS AND OTHER EROSION CONTROL MEASURES SHALL BE MAINTAINED BY THE CONTRACTOR. AT COMPLETION OF CONSTRUCTION, THE CONTRACTOR SHALL COORDINATE THE TRANSFER OF MAINTENANCE RESPONSIBILITIES, IF REQUIRED, WITH THE OWNER. MAINTENANCE SHALL BE IN ACCORDANCE WITH DHEC'S MANUAL, "SOUTH CAROLINA STORMWATER MANAGEMENT AND SEDIMENT CONTROL HANDBOOK FOR LAND DISTURBANCE ACTIVITIES".
 27. ALL EROSION CONTROL PRACTICES SHALL BE IN ACCORDANCE WITH "SOUTH CAROLINA STORMWATER MANAGEMENT AND SEDIMENT CONTROL HANDBOOK FOR LAND DISTURBANCE ACTIVITIES".
 28. EXISTING VEGETATION SHALL BE PROTECTED AS MUCH AS PRACTICAL.
 29. IF SYNTHETIC OR PERMANENT VEGETATIVE MATTING IS USED, THE MANUFACTURER'S REPRESENTATIVE WILL APPROVE, IN WRITING, THE INSTALLATION OF THE MATERIAL. A LETTER WILL BE PROVIDED TO THE ENGINEER AND OWNER.
 30. IF THE INSTALLATION OF THE STORM DRAINAGE SYSTEM IS INTERRUPTED BY WEATHER OR NIGHTFALL, PIPE ENDS SHALL BE COVERED WITH FILTER FABRIC.
 31. ALL TEMPORARY STRUCTURES SHALL BE REMOVED ONCE CONSTRUCTION IS COMPLETE AND THE SITE IS STABILIZED.
 32. THE CONTRACTOR SHALL RESPREAD THE TOPSOIL ON SITE AS MUCH AS POSSIBLE PRIOR TO FINAL GRADING AND STABILIZATION.
 33. THIS PLAN SHALL NOT BE CONSIDERED ALL INCLUSIVE. THE CONTRACTOR SHALL TAKE ALL NECESSARY MEASURES AT HIS EXPENSE TO REDUCE EROSION AND PREVENT SEDIMENT FROM LEAVING THE SITE. THE CONTRACTOR IS RESPONSIBLE FOR ALL CLEANUP AND REPAIR ON-SITE AND DOWNSTREAM DUE TO EROSION AND SILTATION.

INDOOR PRACTICE AREA
FF=187.80

OUTDOOR
FOOTBALL
PRACTICE
FIELDS
N.I.C.

NOTE TO CONTRACTOR:
SEE PLAN SHEET R-100 FOR THE GRADING OF THE OUTDOOR FOOTBALL PRACTICE FIELDS. THE PROPOSED GRADES SHOWN ON R-100 ARE INTENDED TO BE THE EXISTING GRADES ON WHICH THIS PROJECT IS BASED.

DESIGNER'S CERTIFICATION:

"I HEREBY CERTIFY THAT THIS PLAN IS DESIGNED TO CONTAIN SOIL ON THE PROPERTY CONCERNED TO THE MAXIMUM EXTENT, TO PROVIDE FOR THE PROTECTION OF THE PROPERTY AND THE PROPOSED IMPROVEMENTS THEREON FROM THE EFFECTS OF FLOODING, TO PROVIDE FOR THE CONTROL OF THE RUNOFF FROM THE PROPERTY, AND THAT ALL PROVISIONS FOR SEDIMENT CONTROL AND STORM DRAINAGE ARE IN ACCORDANCE WITH THE STORMWATER MANAGEMENT AND SEDIMENT CONTROL ORDINANCE FOR THE CITY OF COLUMBIA, SOUTH CAROLINA.

DATE: 2/5/14
DARREN K. HOLCOMBE
REGISTERED PROFESSIONAL ENGINEER NO. 14890

APPLICANT'S CERTIFICATION:

"I (WE) HEREBY CERTIFY THAT ALL CLEARING, GRADING, CONSTRUCTION, AND/OR DEVELOPMENT WILL BE DONE PURSUANT TO THIS PLAN AND I (WE) ARE RESPONSIBLE FOR THE LAND DISTURBANCE AND RELATED MAINTENANCE THEREOF. CITY OF COLUMBIA AUTHORITIES WILL BE ALLOWED TO ENTER THE PROJECT SITE FOR THE PURPOSE OF ON-SITE INSPECTIONS."

DATE: 2/5/14
PERMIT APPLICANT

NOTE TO CONTRACTOR REGARDING PHASED SWPPP

THE INTENT OF THE PHASED SWPPP IS TO LIMIT THE AMOUNT OF EXPOSED SOIL DURING CONSTRUCTION TO PREVENT LOSS OF SEDIMENT. THE CONTRACTOR MUST REVIEW ALL PORTIONS OF THE SWPPP TO UNDERSTAND EACH PHASE AND THE PURPOSE OF THE PHASING. THERE WILL BE INFORMATION CONTAINED IN THE CONSTRUCTION PHASE SWPPP AND DETAILS THAT WILL BE NEEDED AS YOU TRANSITION FROM INITIAL PHASE TO CONSTRUCTION PHASE. CONSULT ALL PLAN SHEETS AND DETAILS TO DETERMINE THE BEST COURSE OF ACTION WHILE KEEPING TO THE OVERALL INTENT OF THESE PHASED SWPPPS. IT IS HIGHLY RECOMMENDED THAT THE CONTRACTOR HAVE THE PROJECT ENGINEER OR SWPPP INSPECTOR PERFORM AN INSPECTION TO VERIFY THAT ALL ELEMENTS OF THE INITIAL SWPPP ARE INSTALLED PROPERLY PRIOR TO MOVING FORWARD WITH THE CONSTRUCTION PHASE SWPPP.

CONSTRUCTION PHASE SEQUENCE:

1. INSURE THAT INITIAL PHASE PERIMETER CONTROLS ARE IN PLACE.
2. ROUGH GRADING.
3. INSTALLATION OF UTILITIES.
4. INSTALL ALL INLET PROTECTION AS SHOWN AND DETAILED.
5. INSTALLATION OF DRIVEWAYS AND PARKING AREAS.
6. PROCEED TO STABILIZATION PHASE SWPPP.

STABILIZATION PHASE CONSTRUCTION SEQUENCE:

1. PERFORM PERMANENT/FINAL STABILIZATION OF ALL AREAS.
2. REMOVAL OF TEMPORARY SEDIMENT AND EROSION CONTROL MEASURES FROM THE ENTIRE AREA.
3. SUBMIT NOTICE OF TERMINATION (NOT) TO THE CITY OF COLUMBIA WITH CHECKLIST AS REQUIRED.

NOTE: CONSTRUCTION SEQUENCE ABOVE IS NOT A CONTRACTUAL SEQUENCE.

GRADING LEGEND

185.50	PROPOSED SPOT ELEVATION
187.80	PROPOSED SPOT ELEVATION TOP AND BOTTOM OF CURB
185	PROPOSED INDEX CONTOUR
186	PROPOSED INTERMEDIATE CONTOUR
180	EXISTING INDEX CONTOUR
181	EXISTING INTERMEDIATE CONTOUR
---	LIMITS OF DISTURBANCE

CODED NOTES

- 1 LIMITS OF DISTURBANCE.
- 2 WIRE-BACKED PERIMETER SILT FENCING. (SEE DETAIL).
- 3 CONCRETE FLUME FOR DRAINAGE.
- 4 HANDICAP PARKING SPACE. THE MAXIMUM SLOPE ALLOWED IN ANY DIRECTION OF A HANDICAP PARKING SPACE IS 2.0%.
- 5 TEMPORARY GRAVEL CONSTRUCTION ENTRANCE.
- 6 INSTALL DROP INLET SEDIMENT FILTER EITHER BLOCK AND GRAVEL OR SEDIMENT TUBE OPTION. SEE DETAIL. CATCH BASIN SEDIMENT FILTER MAY BE USED AS AN ALTERNATE. SEE DETAIL.
- 7 SIDEWALK TO BE FLUSH WITH PAVEMENT IN THIS AREA.
- 8 HANDICAP ROUTE AND RAMP. THE MAXIMUM CROSS SLOPE ALLOWED ON A HANDICAP ROUTE IS 2.0%. THE MAXIMUM LONGITUDINAL SLOPE ON A HANDICAP ROUTE IS 4.99%, AND THE MAXIMUM RISE ON A HANDICAP RAMP IS 6" AND CAN NOT EXCEED 8.33% SLOPE (1/12).
- 9 INSTALL RIP-RAP APRON OUTLET PROTECTION ON SILT FENCING FABRIC TAKING CARE NOT TO TEAR FABRIC. EXCAVATE RIP-RAP AREA TO SPECIFIED DEPTH BELOW THE FINISH GRADE PRIOR TO INSTALLING THE RIP-RAP. SEE RIP-RAP APRON OUTLET PROTECTION DETAIL.
- 10 CONTRACTOR SHALL SEED ONLY THOSE AREAS WITHIN PROJECT LIMITS SHOWN ON SHEET C-101. SEE TEMPORARILY SEEDBED PREPARATION AND SEEDING SCHEDULE ON SHEET C-402.

NOTE: LIMITS OF DISTURBANCE SHOWN ON THIS PLAN IS FOR PERMITTING PURPOSES ONLY AND NOT INTENDED TO INDICATE THE CONTRACTORS WORK LIMITS. SEE PROJECT LIMITS ON SHEET C101 FOR THE ACTUAL LIMIT OF WORK FOR THIS PROJECT.

The Palmetto Utility Protection Service, Inc.
3 DAYS BEFORE DIGGING IN SOUTH CAROLINA
CALL 811
CONTRACTOR SHALL CONTACT THE UNDERGROUND LOCATORS EVERY 10 DAYS FOR AN UPDATE TO UTILITY LOCATIONS.

NOTE:
INFORMATION REGARDING THE REPUTED PRESENCE, SIZE, CHARACTER AND LOCATION OF EXISTING UNDERGROUND UTILITIES AND STRUCTURES WAS OBTAINED FROM LOCAL UTILITY COMPANIES AND IS SHOWN HEREON AS SHOWN ON THESE DRAWINGS. COX AND DINKINS, INC. HAS NO KNOWLEDGE OF ANY FACTS THAT WOULD LEAD US TO CONCLUDE THAT THE INFORMATION IS NOT ACCURATE, BUT UTILITIES AND STRUCTURES NOT SHOWN MAY BE ENCOUNTERED. THE OWNER, HIS EMPLOYEES, HIS CONSULTANTS, HIS AGENTS AND HIS CONTRACTORS SHALL HEREBY INSTRUCTED AND UNDERSTAND THAT COX AND DINKINS, INC. IS NOT RESPONSIBLE FOR THE CORRECTNESS OR SUFFICIENCY OF THE UNDERGROUND INFORMATION. INFORMATION WITH RESPECT TO ABOVE GROUND MONUMENTS OF SUCH UTILITIES IS BASED UPON ACTUAL FIELD MEASUREMENTS AND OBSERVATIONS, AND IS SHOWN HEREON.

REFERENCES:

- 1) PLAT PREPARED FOR UNIVERSITY OF SOUTH CAROLINA, BY COX AND DINKINS, INC., DATED JANUARY 14, 2008.
- 2) A PLAT OF BOUNDARY SURVEY AND TOPOGRAPHIC MAP OF RICHLAND COUNTY TAX PARCELS R11205-01-09A, R11205-01-05 & R11205-01-06, PREPARED BY THE UNIVERSITY OF SOUTH CAROLINA, BY MILBUR SMITH ASSOCIATES, DATED NOVEMBER 26, 2008, REVISED DECEMBER 11, 2008.

NOTES:

- 1) THE LOCATIONS OF OTHER UNDERGROUND UTILITIES ARE UNKNOWN.
- 2) THE CONTOUR INTERVAL IS ONE (1) FOOT.
- 3) ALL DIMENSIONS ARE TO THE FACE OF CURB UNLESS OTHERWISE NOTED.
- 4) VERTICAL DATA SHOWN HEREON IS BASED ON PUBLISHED VALUES FOR RICHLAND COUNTY CONTROL MONUMENT R0579711AZ, HAVING A PUBLISHED ELEVATION OF 187.50, BASED ON NAVD 88 DATUM.

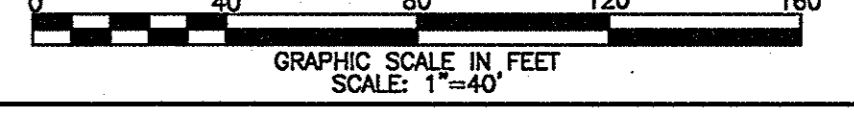

COX AND DINKINS
ENGINEERS - SURVEYORS
COX AND DINKINS, INC.
174 BELTLINE BLVD.
COLUMBIA, SC 29205
803-254-0518
803-785-0983
Email: cdinc@coxanddinkins.com

SOUTH CAROLINA
REGISTERED PROFESSIONAL ENGINEER
No. 14890

SOUTH CAROLINA
REGISTERED PROFESSIONAL ENGINEER
No. C03294

CERTIFICATE OF AUTHORIZATION SEAL

ARCHITECTURE
INTERIORS
PLANNING

WTS
WATSON TATE SAVORY

RATIO

INDOOR PRACTICE FACILITY
CONSTRUCTION
UNIVERSITY OF SOUTH CAROLINA
COLUMBIA, SC
Site Project No: H27-6090-AU

Project Number: 12710
Date: FEBRUARY 5, 2014

Revisions:

1	3/20/14	REVISE S&E/C

GRADING AND SWPP PLAN

C-201

CONSTRUCTION DOCUMENTS